

# [SMART]:LIVING

## Indoor Air Quality Monitor Detector Gas Detector Desktop Air Quality Tester

Detecting: PM2.5,HCHO,TVOC, AQI,PM1.0,PM10 Measurement Range:  
 PM2.5 :0-999 ug/M3TVOC: 0.001-9.999Mg/M3AQI: 0-500HCHO: 0.001-1.999Mg/M3

**Smart Living Homes: What can one do to keep your Family Healthy?** We provide Families a way for Health Issues to be prevented- Resolved Sensors in Smart Living Homes, will monitor measure, protect and Fix any issue until you or an appointee can fix the issue, thereafter you know you family is safe and you can reactivate the sensor after you have a resolve to the emergency Sensors

Accuracy: High Precision  
 Sensor style: Laser  
 Power supply: Built in Li-battery3000mAh  
 Usage: Air quality detector  
 Material: Metal  
 Color: Black  
 Warranty: 12 Months  
 Certificate: CE.Rohs.ISO9001



### Product Description

PM2.5/1.0/10, temperature, and humidity on its digital LCD display. **This product is a multifunctional air quality detector that detects Formaldehyde (HCHO), Total Volatile Organic Compounds (TVOC), Particulate Matter <2.5 micron-sized particles (PM2.5/1.0/10), Temperature, and Humidity with clock and record function.** As a scientific air quality detection device, it combines multiple air sensors with a built-in fan to allow real-time monitoring of formaldehyde (HCHO), total volatile organic compounds (TVOC),



### Product Specifications

Display method: 4.3" LCD screen display  
 Atmospheric pressure: 86Kpa - 106Kpa  
 Detection method for PM: Laser Scattering  
 Sampling time: 1.5 seconds  
 Product Size: 131\*78\*67.5 MM  
 Relative humidity: 20% - 85%  
 Storage temperature: -10°C to 60°C; 14°F to 140°F  
 Concentration unit for HCHO and TVOC: mg/m<sup>3</sup>  
 5V DC power charging via micro USB port  
 Product weight: 570g  
 Detection temperature: -10°C to 50°C; 14°F to 122°F  
 Power source: Lithium battery with 3000 mAh capacity;



The test index included for air quality monitor? A : PM2.5: is main for smog(PM1.0 and PM10 are the same); HCHO: is for formaldehyde; TVOC: is main for benzene, etc Volatile organic compounds; AQI: is for Integrated air quality index.

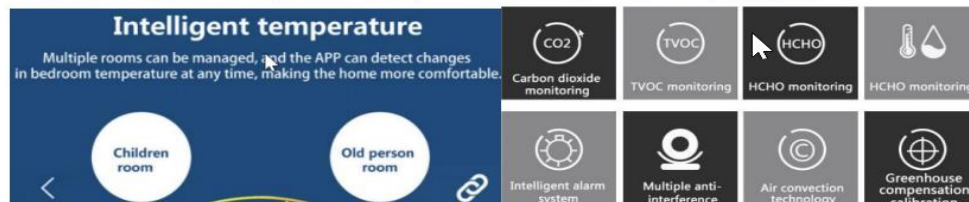

Its important to detect it but also we have the technology to eliminate all the pollutants and Filter the air to eliminate them. Many illnesses can improve via the assistance of Air & Dust Quality, those with asthma or emphysema and other airborne illnesses with now have protection.

Air Quality is the most important issue we face today combined with Viruses and Bacteria. Gas fumes of all types can affect your Family so we have for health and other protection incorporate also Gas sensors.

Air borne Viruses and Bacteria and dust and polluted Air in your Home. Many Viruses and Bacteria are airborne and with one's home we have the technology to eliminate 99% of them in protection of your Family.



### WHAT CAN IT DO FOR YOU?

Nobico Wall-mounted air purifier



## Smart Living Remote Control Universal Infrared WIFI Bluetooth IR Mobile Controller

Tv Air Conditioner, Heat pump, Vacuum Robot Plus. Smart Living smart IR remote App

Feature: WIFI  
 Display Colour Black / White  
 Use: Universal  
 Design: Rotatable  
 Model: smart ir remote  
 Wireless Type: 2.4GHz  
**Function: support all infrared devices**  
 App Alarm: yes  
 Max power: 0.55W  
 Push notification: Yes  
 Protocol: IEEE 802.11b/g/n  
**Wireless distance: 45 meters**  
 Certificates: CE ROHS  
 Guarantee: 1 year  
**Power supply: USB Cable charged, 5V 1A**  
**Infrared distance: 7M**  
**Infrared angle: 360 degree**  
**Wireless range: 45m**  
**Size: 67\*67\*24mm**



## Smart Living WiFi Smart IR Controller for all Infrared Remotes

Functions: Support all infrared devices, including AC, TV, LED, fan, DVD player, etc  
 Support Amazon Alexa and Google Home  
 DIY learning mode to controls all devices the use infrared signals  
 Infrared frequency 38-56Khz

Smartphone Remote Control to Make Your Home Smarter



# [SMART]:LIVING

## Latest Technology Purifier & Uvc Sterilizer Activated Carbon Air Purifier With H12 Hepa Filter

**Don't be a human vacuum cleaner**

Air pollution has seriously affected people's health



AP1210

Capacity (CFM):71

Dimensions (L x W x H

(Inches):210\*210\*321mm

Power (W):30W

Voltage (V):220~240V

Warranty:1 Year, ONE YEAR

Type: Activated Carbon Air Filter, home air purifier

Power Source: Electric

PM CADR:120

App-Controlled: Yes

Gaseous Pollutant CADR: 120

Featured Function: WIFI control

Recommended Room Size (square feet):151

Air Quality Display: Yes

Timer: Yes

Applicable Area: 86~151

Filter: HEAP

Noise: <50db

Keyword: Pm2.5 Display

Motor: DC

Sensor: PM2.5 Sensor

Product name: UVC air purifier

Weight: 2.5kg

**Even if you have a pet at home,  
you can breathe easily.**

Cats and dogs have a lot of fun at home. But dog/cat hair is everywhere in the house, and the unknowing stench in the corner fills the room as it ferments through the summer/heating room.



**Caring for your family  
begins with healthy breathing**

Remove virus/haze/odor/allergen



**Sleep soundly all night**

Sleep mode, more quiet than you think, 30 decibels of quiet work, clean air volume is still strong, sleep mode only breathing sound.



Efficient removal of second-hand smoke/formaldehyde/toluene/odor/pollen, etc

**BREATHE FREELY**

— AP1207 —

AREA: 14m<sup>2</sup>

CADR: 120M<sup>3</sup>/h



**Desktop air purifier**

CADR: 120M<sup>3</sup>/H

Cover area: 14m<sup>2</sup>

Purification systems: Pre-filter; HEPA filter; Activated carbon filter; anion

# Tuya Smart App Connection Guide



1. Scan the QR code specified above, download and install the Tuya smart APP;

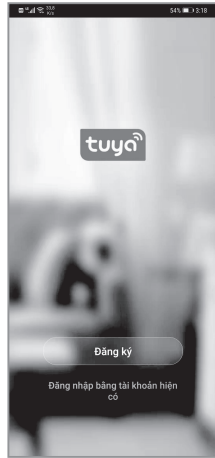

2. Open the Tuya smart APP and choose to create a new account or log in directly;



3. Click the "+" sign in the upper right corner to add the device;

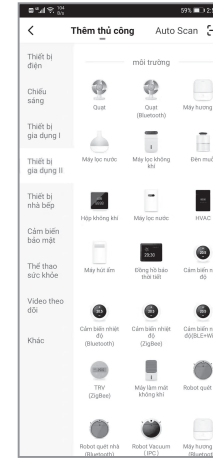

4. Select "small home appliance - air purifier";  
Turn on the air purifier, and press "MODE" to enter the distribution network mode within five seconds, see the WIFI indicator on the front panel flashes;

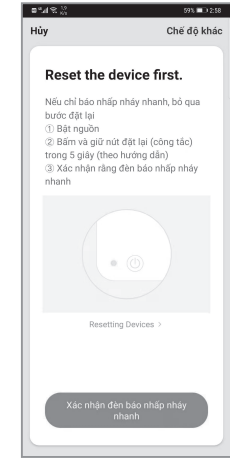

5. Click "confirm indicator rapidly blink";

Note: please ensure that the mobile phone and air purifier are in the same WIFI environment;

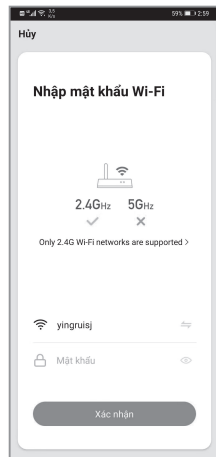

6. Enter the WIFI password and click ok;

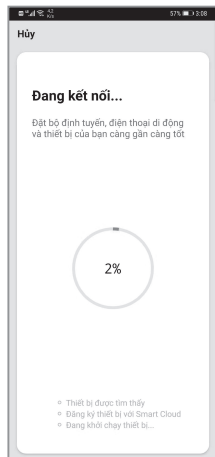

7. Wait for device connection to complete;

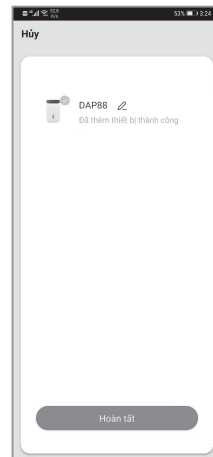

8. "Add device success" appears to indicate that the device connection was successful;

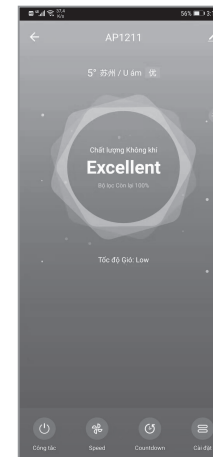

9. Click finish to enter the control interface to control the machine;